

## igubal<sup>®</sup> spherical thrust bearings

Easy to fit

Compensation of misalignment errors

Resistant to edge loads

Very good friction and wear properties



igubal® self-aligning spherical thrust bearings are very easy to fit and help to compensate for alignment errors and prevent edge pressure.



Easy to fit

Compensation of  
misalignment errorsResistant to  
edge loadsVery good friction  
and wear properties**When to use it?**

- If you want to save weight
- If corrosion resistance is requested
- If a bearing with a good coefficient of friction is required

**When not to use it?**

- At very high loads
- When temperatures are higher than +80°C
- When high speeds have to be achieved

**Available from stock**

Detailed information about delivery time online.

**Price breaks online**

No minimum order value. No minimum order quantity



Max. +80°C

Min. -30°C



Type 1

Ø 5–20mm



Online product finder

► [www.igus.eu/igubal-finder](http://www.igus.eu/igubal-finder)

**Mechanical properties**

igubal® self-aligning spherical thrust bearings are very easy to fit and help to compensate for alignment errors and prevent edge pressure. The housing pad is made of the impact-resistant, thermoplastic composite igumid G. The spherical washer is made of iglidur® W300 material. This combination provides exceptionally good friction and wear properties.

**Loads**

The load capacity of igubal® spherical thrust bearings is very high in standard ambient temperatures. For high continuous loads and high temperatures, the load capacity of the spherical thrust bearings should be tested in an experiment that simulates the application.

**Coefficient of sliding friction and speed**

Taking into account the radial load, maximum surface speeds up to 0.5m/s rotating are possible.

**Assembly**

The housing pad is installed so that it is countersunk and secured. The spherical washer is loosely fitted in the socket and is held in place by the shaft that is placed into the bearing.

**Product range**

igubal® spherical thrust bearings are available in standard form to suit diameters from 5 to 20mm. Please contact us if you require other dimensions.

Spherical thrust bearings: SAM



Spherical washer

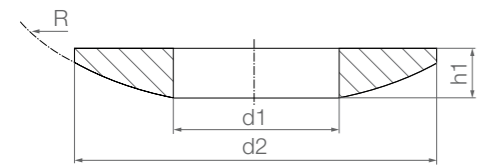

Housing pad



Technical data

Part No.	Max. static axial compressive strength		Weight [g]
	Short-term	Long-term	
	[N]	[N]	
SAM-05	4,000	2,000	0.9
SAM-06	5,000	2,500	1.1
SAM-08	8,000	4,000	2.2
SAM-10	10,000	5,000	3.4
SAM-12	12,000	6,000	5.9
SAM-16	17,000	8,500	8.5
SAM-20	22,000	11,000	12.8

Dimensions [mm]

Part No.	d1 Spherical washer DIN 2768 medium	d3 Housing pad DIN 2768 medium	d2	h1 Spherical washer	h2 Housing pad	H <sup>34)</sup> Overall height	R Radius	Compensation angle
SAM-05	5.2	7.0	15	3.0	3.5	4.7	15	3°
SAM-06	6.2	7.5	16	3.0	4.0	5.3	16	3°
SAM-08	8.2	10.0	20	4.0	5.0	6.8	20	2°
SAM-10	10.2	12.0	24	4.5	5.5	7.5	24	2°
SAM-12	12.5	14.5	30	5.0	6.2	8.0	32	2°
SAM-16	16.2	19.0	36	5.5	6.5	8.7	40	2°
SAM-20	20.2	23.0	44	6.0	7.0	8.6	45	2°

<sup>34)</sup> In assembled condition

Order key

Type  Size [mm]

SA M-05



Material:  
Spherical washer: iglidur® W300 ▶ Page 171  
Housing pad: igumid G ▶ Page 1654

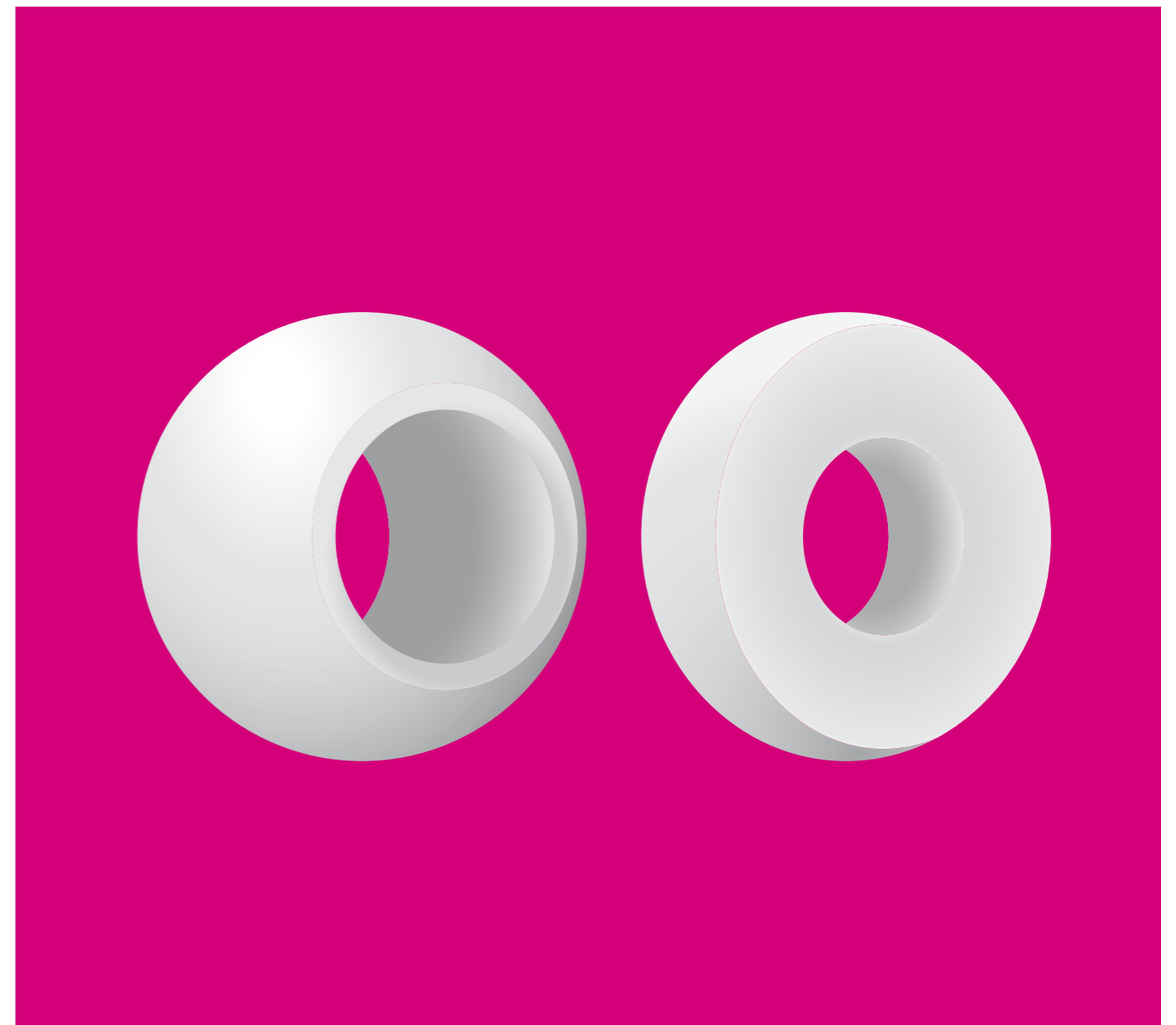

igubal® spherical balls

Maintenance-free dry operation

Corrosion-free

High compressive strength

Flexible

Lightweight

Different materials

Spherical balls for metallic bearing housings

