

Flat, lightweight and lubrication-free

Lubrication-free linear modules – drylin® SLT

The low profile, the lateral lead screw arrangement and a striking design, are just some of the reasons why the drylin® SLT linear module was honoured with the 2014 IF Award. Technically, the system impresses with ball bearing mounted trapezoidal or high helix thread lead screws for motorised or manual operation. The basis of the SLT series is the drylin® T miniature guide in sizes 12 and 15.

- Low-profile structure through lateral lead screw arrangement
- Lubrication-free, corrosion-resistant, lightweight
- Variable pitch
- Adjustable drylin® T miniature carriage
- Lead screw arrangement can be selected either left or right

Typical application areas

- Format adjustments
- Laboratory and medical technology
- Optical equipment

 **Available in 3–8 days**
Detailed information about delivery time online.

 **Max. +60°C**
Min. -40°C

 **Stroke lengths 300–600mm**
More dimensions upon request.

 **Product finder**
▶ www.igus-asean.com/slt-productfinder

 **In accordance with EU Directive 2011/65/EU (RoHS 2)**
Restriction (of the use of certain) hazardous substances

Shaft end supports/ carriages made of anodised aluminium

Ball bearing supported lead screws

Lead screw arrangement left or right of the carriage

Self-locking trapezoidal thread or fast adjustment with high helix thread

drylin® T miniature carriage with individual clearance adjustment

Lead screws of steel or stainless steel

Hard-anodised drylin® T miniature guide rail

Hand wheel, position indicator and lead screw clamp as accessories

▶ Page 1503

 **Can be configured as ready-to-connect linear axis with motor and initiators**

▶ www.igus-asean.com/drylin-automation



2013

With ball bearing supported lead screw

 **Order key**

Order example

SLT-BB-0412- E R-S 0015 R G-□

| | | | | | | | | | |
|------|--------|-------------------|-------------------------|----------------------|------------|-------|--------|----------------|---------------------|
| Type | Design | Installation size | Adjustable carriage TWE | Lead screw alignment | Lead screw | Pitch | Thread | Lead screw end | Stroke length in mm |
|------|--------|-------------------|-------------------------|----------------------|------------|-------|--------|----------------|---------------------|

Options:

| | | |
|-----------------------------|----------------------|-----------------------|
| Design | Lead screw | Lead screw end |
| BB = With ball bearings | S = Steel | G = Threaded end |
| Lead screw alignment | ES = Stainless steel | |
| R = Right (standard) | Thread | |
| L = Left | R = Right | |

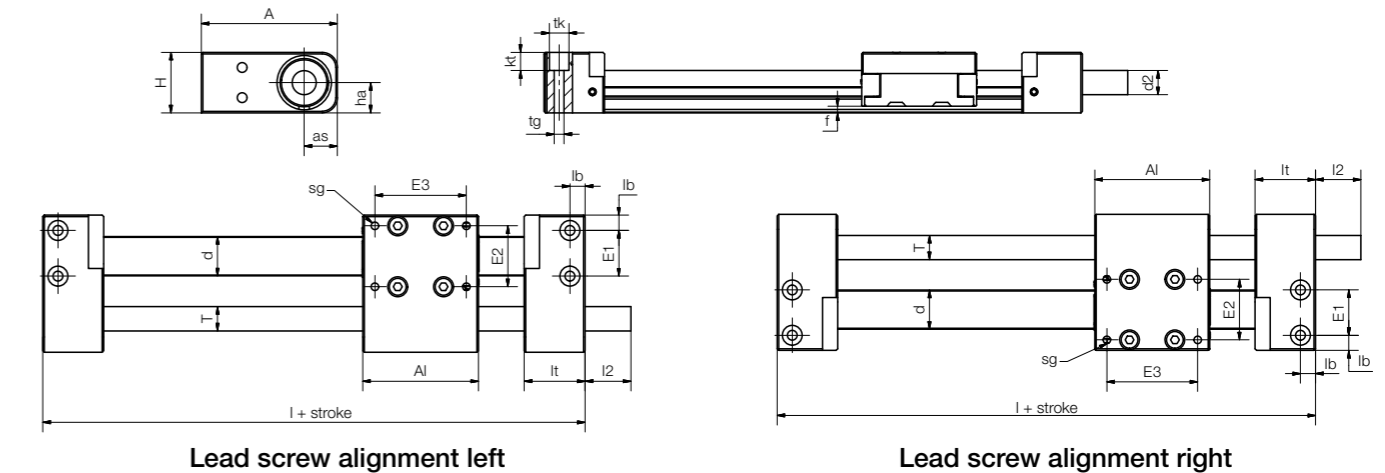

Technical data and dimensions [mm]

| Part No. | Pitch | Max. stroke length | Weight | | Max. static load capacity | | Max. rpm | Max. speed |
|-------------|----------|--------------------|------------------------|------|---------------------------|------------|----------|------------|
| | | | Additional (per 100mm) | [kg] | Axial [N] | radial [N] | | |
| SLT-BB-0412 | Tr08x1.5 | 300 | 0.15 | 0.06 | 100 | 200 | 1,000 | 1.5 |
| | Sg08x15 | 300 | 0.15 | 0.06 | 25 | 100 | 600 | 9.0 |
| SLT-BB-0415 | Tr12x3 | 600 | 0.40 | 0.12 | 200 | 400 | 1,000 | 4.5 |
| | Sg12x25 | 600 | 0.40 | 0.12 | 50 | 200 | 300 | 7.5 |

| Part No. | A | Al | H | E1 | E2 | E3 | l | l2 | d2 | ha | sg | tk | kt | tg | f | lb | lt | d | T | as |
|-------------|----|----|----|----|----|----|----|----|----|----|-------|-----|-----|-------|-----|-----|----|----|----------|----|
| SLT-BB-0412 | 45 | 38 | 20 | 15 | 20 | 30 | 78 | 15 | - | 10 | M3-7 | 6.5 | 6 | M4 | 2.2 | 5 | 20 | 13 | Tr08x1.5 | 11 |
| SLT-BB-0415 | 58 | 45 | 30 | 19 | 25 | 35 | 89 | 17 | 12 | 15 | M3-13 | 8 | 4.5 | M5-15 | 2.8 | 6.5 | 22 | 17 | Tr12x3 | 16 |

Also see econ chapter ▶ Page 1455