

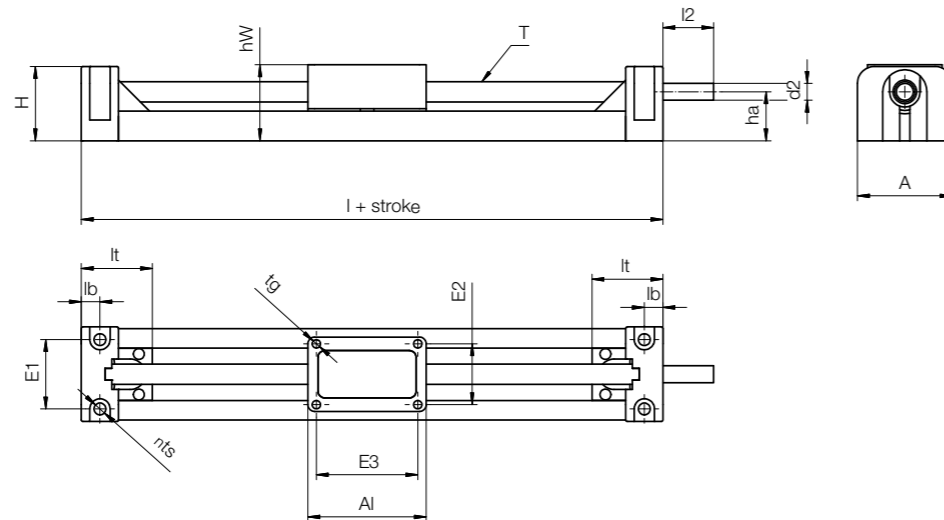

- SLNV linear module for the smallest applications
- For stroke lengths up to 250mm
- High precision due to stop motion pre-load prism slide
- Clearance reduction in z and y directions due to pre-load
- Lead screw with plain or ball bearing
- Self-locking with trapezoidal thread Tr6x2
- Fast and efficient with pre-load
- Feed rate up to 25.4mm per rotation

Typical application areas:

- Medical technology
- Dental equipment
- Research and development
- Measuring technology



Technical data

Part No.	Max. stroke length [mm]	Weight		Max. static load capacity		Max. Speed [rpm]	Max. Drive torque [N]
		[g]	Additional (per 100mm) [g]	Axial	radial		
SLNV-27-0025	250	80	56	10	40	300	0.1
SLNV-27-0051	250	80	56	10	40	300	0.1
SLNV-27-0127	250	80	56	10	40	300	0.1
SLNV-27-0254	250	80	56	10	40	300	0.1

Dimensions [mm]

Part No.	A	A1	H	E1	E2	E3	I	hw	lt	lb	ts	tg	d2 ⁹⁸⁾	l2	ha
	±0.2	-0.1	±0.2	±0.15	±0.15	±0.15		±0.3	±0.2				4 h7		
SLNV-27-0025	28	35	22	20.5	18	30	77	22.5	21	5.5	3.5	6.35x2.54	5	15	14.5
SLNV-27-0051	28	35	22	20.5	18	30	77	22.5	21	5.5	3.5	6.35x5.08	5	15	14.5
SLNV-27-0127	28	35	22	20.5	18	30	77	22.5	21	5.5	3.5	6.35x12.7	5	15	14.5
SLNV-27-0254	28	35	22	20.5	18	30	77	22.5	21	5.5	3.5	6.35x25.4	5	15	14.5

⁹⁸⁾ Thread/remaining thread visible

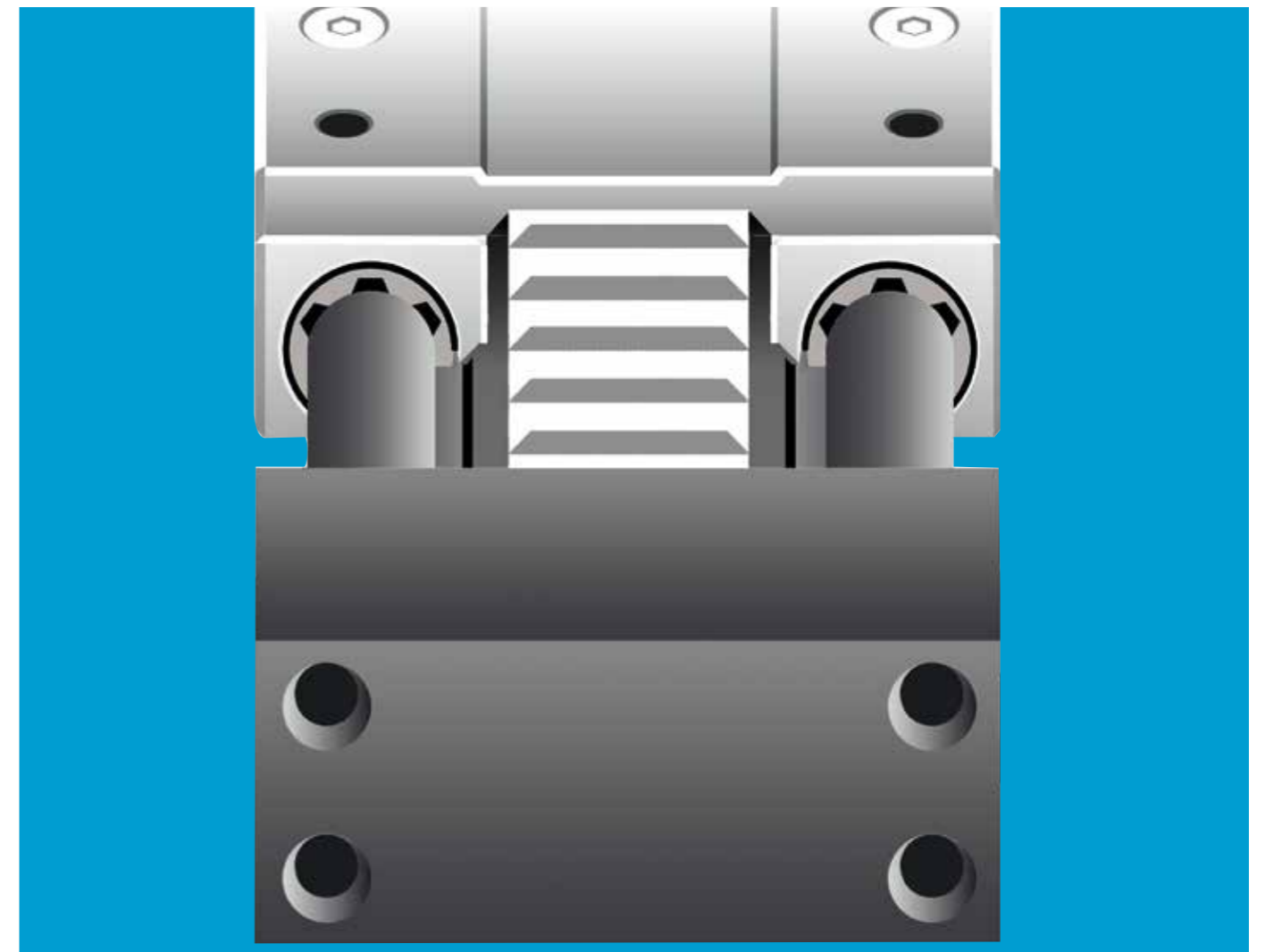

drylin® general drive technology – Toothed belt axes

Lubrication-free linear modules based on
drylin® W guides

Drive: Toothed belt

For fast positioning

End supports with deep groove ball bearings

As single axis or for multi-axis linear robots

