

Order key

Type d2 b1 Thread

S R M-2215TR10X2

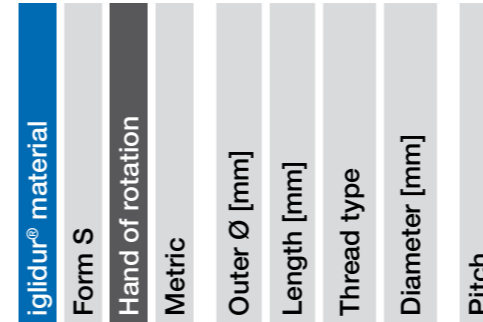

Options:
Hand of rotation
R: Right-hand thread
L: Left-hand thread

- J** High efficiency at all speeds
- W(300)** Extremely strong and wear-resistant
- J350** For temperatures up to +150°C
- R** The cost-effective option for high volume
- A180** FDA-compliant for the food and pharmaceutical industries

Technical data

Thread	Hand of rotation		Effective supporting surface [mm²]	Max. stat. axial F [N]				
	right	left		igidur®				
				J	W300	J350	R	A180
Tr8x1.5	●	●	205	500 ⁴³⁾	500 ⁴³⁾	500 ⁴³⁾	500 ⁴³⁾	500 ⁴³⁾
Tr8x1.5	●	●	137	547	683	410	273	478
Tr10x2	●	●	212	848	1,060	636	424	742
Tr10x2	●	●	283	1,131	1,414	848	565	990
Tr10x3	●	●	200	801	1,001	601	401	701
Tr10x3	●	●	267	1,068	1,335	801	534	935
Tr12x3	●	●	297	1,188	1,484	891	594	1,039
Tr12x3	●	●	396	1,583	1,979	1,188	792	1,385
Tr14x3	●	●	550	2,199	2,749	1,649	1,100	1,924
Tr14x4	●	●	396	1,583	1,979	1,188	792	1,385
Tr14x4	●	●	528	2,111	2,639	1,583	1,056	1,847
Tr16x2	●	●	565	2,262	2,827	1,696	1,131	1,979
Tr16x2	●	●	754	3,016	3,770	2,262	1,508	2,639
Tr16x4	●	●	528	2,111	2,639	1,583	1,056	1,847
Tr16x4	●	●	528	2,111	2,639	1,583	1,056	1,847
Tr16x4	●	●	704	2,815	3,519	2,111	1,407	2,463
Tr18x4	●	●	679	2,362 ⁴³⁾	2,362 ⁴³⁾	2,362 ⁴³⁾	2,362 ⁴³⁾	2,362 ⁴³⁾
Tr18x4	●	●	679	2,714	3,393	2,036	1,357	2,375
Tr18x4	●	●	905	3,619	4,524	2,714	1,810	3,167

⁴³⁾ Reduced axial load due to nut geometry

Dimensions [mm]

d1 ¹⁵⁶⁾	d2 ¹⁵⁶⁾	b1 ¹⁵⁶⁾	Weight [g]					Part No.
			igidur®					
			J	W300	J350	R	A180	
8	14	18	2.8	2.9	2.7	2.6	2.7	<input type="checkbox"/> S <input type="checkbox"/> M-1418TR8X1.5
8	18	12	3.7	3.8	3.5	3.4	3.6	<input type="checkbox"/> S <input type="checkbox"/> M-1812TR8X1.5
10	22	15	6.7	7.0	6.5	6.3	6.6	<input type="checkbox"/> S <input type="checkbox"/> M-2215TR10X2
10	22	20	9.0	9.3	8.7	8.4	8.8	<input type="checkbox"/> S <input type="checkbox"/> M-2220TR10X2
10	22	15	6.7	7.0	6.5	6.3	6.6	<input type="checkbox"/> S <input type="checkbox"/> M-2215TR10X3
10	22	20	9.0	9.3	8.7	8.4	8.8	<input type="checkbox"/> S <input type="checkbox"/> M-2220TR10X3
12	26	18	11.2	11.6	10.8	10.5	11.0	<input type="checkbox"/> S <input type="checkbox"/> M-2618TR12X3
12	26	24	14.9	15.4	14.4	13.9	14.6	<input type="checkbox"/> S <input type="checkbox"/> M-2624TR12X3
14	30	28	23.1	23.8	22.3	21.5	22.6	<input type="checkbox"/> S <input type="checkbox"/> M-3028TR14X3
14	30	21	17.3	17.9	16.7	16.1	17.0	<input type="checkbox"/> S <input type="checkbox"/> M-3021TR14X4
14	30	28	23.1	23.8	22.3	21.5	22.6	<input type="checkbox"/> S <input type="checkbox"/> M-3028TR14X4
16	36	24	29.2	30.1	28.2	27.2	28.6	<input type="checkbox"/> S <input type="checkbox"/> M-3624TR16X2
16	36	32	38.9	40.2	37.6	36.3	38.2	<input type="checkbox"/> S <input type="checkbox"/> M-3632TR16X2
16	30	24	18.1	18.7	17.5	16.9	17.7	<input type="checkbox"/> S <input type="checkbox"/> M-3024TR16X4
16	36	24	29.2	30.1	28.2	27.2	28.6	<input type="checkbox"/> S <input type="checkbox"/> M-3624TR16X4
16	36	32	38.9	40.2	37.6	36.3	38.2	<input type="checkbox"/> S <input type="checkbox"/> M-3632TR16X4
18	30	27	18.2	18.8	17.6	17.0	17.8	<input type="checkbox"/> S <input type="checkbox"/> M-3027TR18X4
18	40	27	40.3	41.6	39.0	37.6	39.5	<input type="checkbox"/> S <input type="checkbox"/> M-4027TR18X4
18	40	36	53.8	55.5	52.0	50.1	52.7	<input type="checkbox"/> S <input type="checkbox"/> M-4036TR18X4

¹⁵⁶⁾ Tolerances according to DIN ISO 2768-1, tolerance class m (medium)

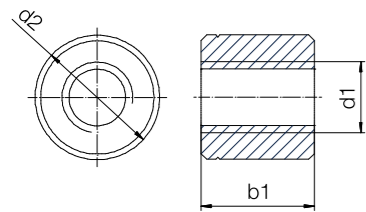

Order key

Type d2 b1 Thread

S R M-30 25 TR 20X4

iglidur® material	Form S
	Hand of rotation
	Metric
	Outer Ø [mm]
	Length [mm]
	Thread type
	Diameter [mm]
	Pitch

Options:
Hand of rotation
R: Right-hand thread
L: Left-hand thread

- J** High efficiency at all speeds
- W(300)** Extremely strong and wear-resistant
- J350** For temperatures up to +150°C
- R** The cost-effective option for high volume
- A180** FDA-compliant for the food and pharmaceutical industries

Technical data

Thread	Hand of rotation		Effective supporting surface [mm²]	Max. stat. axial F [N]				
	right	left		iglidur®				
				J	W300	J350	R	A180
Tr20x4	●	●	707	2,060 ⁴³⁾	3,534	2,121	1,414	2,474
Tr20x4	●	●	848	3,393	4,241	2,545	1,696	2,969
Tr20x4	●	●	1,131	4,524	5,655	3,393	2,262	3,958
Tr24x5	●	●	1,216	4,863	6,079	3,647	2,432	4,255
Tr24x5	●	●	1,621	6,484	8,105	4,863	3,242	5,674
Tr26x5	●	●	1,440	5,759	7,198	4,319	2,879	5,039
Tr26x5	●	●	1,920	7,678	9,598	5,759	3,839	6,718
Tr28x5	●	●	1,682	6,729	8,412	5,047	3,365	5,888
Tr28x5	●	●	2,243	8,972	11,215	6,729	4,486	7,851
Tr30x6	●	●	1,909	7,634	9,543	5,726	3,817	6,680
Tr30x6	●	●	2,545	10,179	12,723	7,634	5,089	8,906
Tr32x6	●	●	3,134	12,535	15,669	9,401	6,267	10,968
Tr36x6	●	●	3,732	14,929	18,661	-	-	13,063
Tr40x7	●	●	4,587	18,347	22,934	-	-	16,054
Tr50x8	●	●	7,226	28,903	-	-	-	-

⁴³⁾ Reduced axial load due to nut geometry

Dimensions [mm]

d1 ¹⁵⁶⁾	d2 ¹⁵⁶⁾	b1 ¹⁵⁶⁾	Weight [g]					Part No.
			iglidur®					
			J	W300	J350	R	A180	
20	30	25	14.6	15.1	14.1	13.6	14.3	<input type="checkbox"/> S <input type="checkbox"/> M-3025TR20X4
20	45	30	57.0	58.9	55.1	53.2	55.9	<input type="checkbox"/> S <input type="checkbox"/> M-4530TR20X4
20	45	40	76.1	78.5	73.5	71.0	74.5	<input type="checkbox"/> S <input type="checkbox"/> M-4540TR20X4
24	50	36	81.1	83.6	78.3	75.6	79.4	<input type="checkbox"/> S <input type="checkbox"/> M-5036TR24X5
24	50	48	108.1	111.5	104.4	100.8	105.9	<input type="checkbox"/> S <input type="checkbox"/> M-5048TR24X5
26	50	39	83.2	85.9	80.5	77.7	81.6	<input type="checkbox"/> S <input type="checkbox"/> M-5039TR26X5
26	50	52	111.0	114.5	107.3	103.5	108.8	<input type="checkbox"/> S <input type="checkbox"/> M-5052TR26X5
28	60	42	138.4	142.8	133.8	129.1	135.6	<input type="checkbox"/> S <input type="checkbox"/> M-6042TR28X5
28	60	56	184.5	190.4	178.3	172.2	180.8	<input type="checkbox"/> S <input type="checkbox"/> M-6056TR28X5
30	60	45	142.2	146.7	137.4	132.6	139.3	<input type="checkbox"/> S <input type="checkbox"/> M-6045TR30X6
30	60	60	189.6	195.6	183.2	176.9	185.8	<input type="checkbox"/> S <input type="checkbox"/> M-6060TR30X6
32	60	60	180.9	186.7	174.8	168.7	177.2	<input type="checkbox"/> S <input type="checkbox"/> M-6060TR32X6
36	75	72	364.8	376.4	-	-	357.4	<input type="checkbox"/> S <input type="checkbox"/> M-7572TR36X6
40	76	80	391.0	403.4	-	-	383.1	<input type="checkbox"/> S <input type="checkbox"/> M-7680TR40X7
50	90	100	655.3	-	-	-	-	<input type="checkbox"/> S <input type="checkbox"/> M-90100TR50X8

¹⁵⁶⁾ Tolerances according to DIN ISO 2768-1, tolerance class m (medium)