

CENTRAL LEVER ENCLOSURES

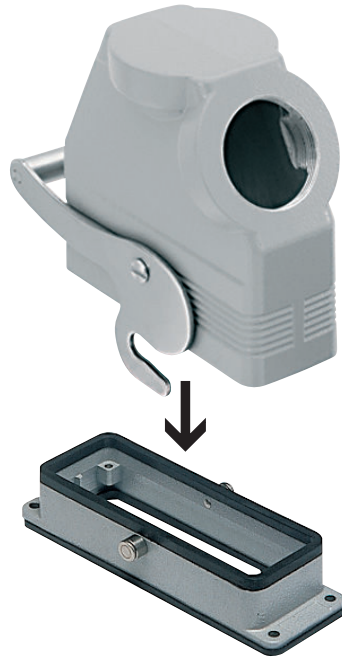

Description

Series specifically designed for industrial applications with limited installation space. These enclosures can be installed, placed side-by-side and handled in a single operation. Furthermore, the lever's shape reduces the effort required to uncouple the inner fittings.

Characteristics of materials used:

CH..YC, CA..YC and MA..YC, CA..YX and MF..YX series

- made of die cast aluminium alloy
- with epoxy-polyester powder coating
- gaskets in anti-aging, oil-resistant, grease-resistant and fuel-resistant vinyl nitrile elastomer
- locking device with single stainless steel lever



| inserts: | | page |
|----------------------|--------------|------------|
| CDD | 24 poles + ⊕ | 59 |
| CQE | 10 poles + ⊕ | 80 |
| CSH | 6 poles + ⊕ | 88 |
| CCE | 6 poles + ⊕ | 94 |
| CNE, CSE, JCNE, JCSE | 6 poles + ⊕ | 95 and 106 |
| CSS | 6 poles + ⊕ | 118 |
| CTE, CTSE *) | 6 poles + ⊕ | 126 |
| MIXO | 2 modules | 156÷195 |

insert centre distance:
44 x 27 mm

bulkhead mounting housings for central lever



surface mounting housings, high construction with two entries for central lever



| description | part no. | part no. | | part no. | |
|--|------------------|---------------------|---------|---------------------|---------|
| | | entry Pg | entry M | entry Pg | entry M |
| bulkhead mounting with pegs for central lever size "44.27" | CHI 06 YC | | | | |
| surface mounting, high construction, with pegs, for central lever size "44.27" | | CAP 06 YC229 | 29x2 | MAP 06 YC232 | 32x2 |

*) can be used only in bulkhead mounting housings
panel cut-out for bulkhead mounting housings in mm

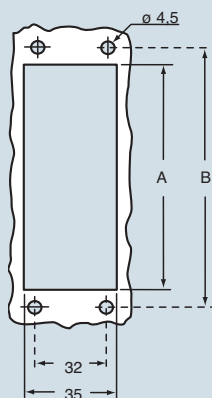

| part | A | B |
|------------------|----|----|
| CHI 06 YC | 52 | 70 |

dimensions in mm

CHI YC

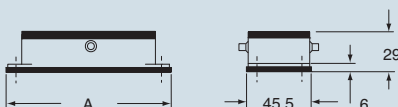

| part | A |
|------------------|------|
| CHI 06 YC | 82.5 |

dimensions in mm

CAP YC and MAP YC

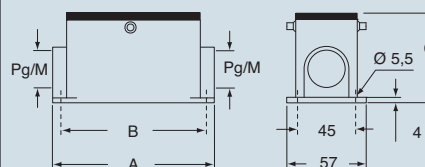

| part | A | B | C |
|------------------------------|----|----|----|
| CAP 06 YC / MAP 06 YC | 82 | 70 | 74 |



dimensions shown are not binding
and may be changed without notice

CENTRAL LEVER - size 44.27



| inserts: | | page |
|----------------------|--------------|------------|
| CDD | 24 poles + ⊕ | 59 |
| CQE | 10 poles + ⊕ | 80 |
| CSH | 6 poles + ⊕ | 88 |
| CCE | 6 poles + ⊕ | 94 |
| CNE, CSE, JCNE, JCSE | 6 poles + ⊕ | 95 and 106 |
| CSS | 6 poles + ⊕ | 118 |
| MIXO | 2 modules | 156÷195 |

insert centre distance:
44 x 27 mm

hoods with central lever



hoods with central lever



| description | part no. | | entry Pg | | part no. | | entry M | |
|--|---|-------------|----------|-------------|-------------|-------------|-------------|-------------|
| | side entry, high construction size "44.27" size "44.27" | CAO 06 YX21 | 21 | MAO 06 YX25 | 25 | CAO 06 YX29 | 29 | MAO 06 YX32 |
| top entry, high construction size "44.27" size "44.27" | | | | | CAV 06 YX21 | 21 | MAV 06 YX25 | 25 |
| | | | | | CAV 06 YX29 | 29 | MAV 06 YX32 | 32 |

dimensions in mm
CAO..YX and MAO..YX

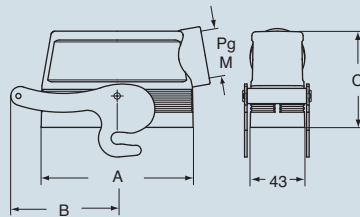

| part | A | B | C |
|---------------------|----|----|----|
| CAO 06 YX/MAO 06 YX | 60 | 66 | 72 |

dimensions in mm
CAV..YX and MAV..YX

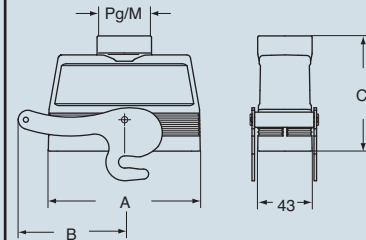

| part | A | B | C |
|---------------------|----|----|--------|
| CAV 06 YX/MAV 06 YX | 60 | 66 | 87 max |

CENTRAL LEVER - size 44.27



dimensions shown are not binding
and may be changed without notice



| inserts: | | page |
|----------------------|---------------------|------------|
| CDD | 42 poles + ⊕ | 61 |
| CQE | 18 poles + ⊕ | 81 |
| CSH | 10 poles + ⊕ | 89 |
| CCE | 10 poles + ⊕ | 96 |
| CNE, CSE, JCNE, JCSE | 10 poles + ⊕ | 97 and 107 |
| CSS | 10 poles + ⊕ | 119 |
| CTE, CTSE *) | 10 poles + ⊕ | 127 |
| CMSE | 3+2 (aux) poles + ⊕ | 135 |
| CMCE | 3+2 (aux) poles + ⊕ | 134 |
| CX | 8/24 poles + ⊕ | 151 |
| MIXO | 3 modules | 156÷195 |

insert centre distance:
57 x 27 mm

bulkhead mounting housings for central lever



surface mounting housings, high construction with two entries for central lever



| description | part no. | part no. | entry Pg | part no. | entry M |
|--|------------------|---------------------|----------|---------------------|---------|
| bulkhead mounting with pegs for central lever size "57.27" | CHI 10 YC | | | | |
| surface mounting, high construction, with pegs, for central lever size "57.27" | | CAP 10 YC229 | 29x2 | MAP 10 YC232 | 32x2 |

*) can be used only in bulkhead mounting housings
panel cut-out for bulkhead mounting housings in mm

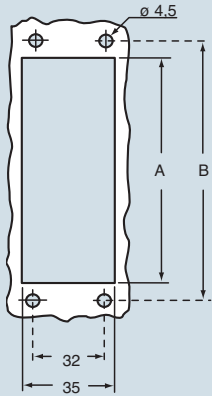

| part | A | B |
|-----------|----|----|
| CHI 10 YC | 65 | 83 |

dimensions in mm

CHI YC

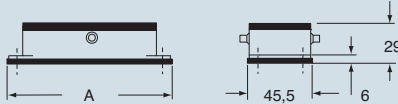

| part | A |
|-----------|------|
| CHI 10 YC | 95.5 |

dimensions in mm

CAP YC and MAP YC

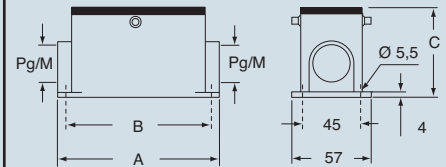

| part | A | B | C |
|-----------------------|------|----|----|
| CAP 10 YC / MAP 10 YC | 93.5 | 82 | 74 |



dimensions shown are not binding
and may be changed without notice

CENTRAL LEVER - size 57.27



| inserts: | | page |
|----------------------|-------------------------|---------|
| CDD | 42 poles + ⊕ | 61 |
| CQE | 18 poles + ⊕ | 81 |
| CSH | 10 poles + ⊕ | 89 |
| CCE | 10 poles + ⊕ | 96 |
| CNE, CSE, JCNE, JCSE | 10 poles + ⊕ 97 and 107 | |
| CSS | 10 poles + ⊕ | 119 |
| CMSE | 3+2 (aux) poles + ⊕ | 135 |
| CMCE | 3+2 (aux) poles + ⊕ | 134 |
| CX | 8/24 poles + ⊕ | 151 |
| MIXO | 3 modules | 156÷195 |

insert centre distance:
57 x 27 mm

hoods with central lever



hoods with central lever



| description | part no. | | entry Pg | | part no. | | entry M | |
|-------------------------------|-------------|----|-------------|----|-------------|----|-------------|----|
| | | | | | | | | |
| side entry, high construction | | | | | | | | |
| size "57.27" | CAO 10 YX21 | 21 | MAO 10 YX32 | 32 | | | | |
| size "57.27" | CAO 10 YX29 | 29 | MAO 10 YX40 | 40 | | | | |
| top entry, high construction | | | | | | | | |
| size "57.27" | | | | | CAV 10 YX21 | 21 | MAV 10 YX32 | 32 |
| size "57.27" | | | | | CAV 10 YX29 | 29 | MAV 10 YX40 | 40 |

dimensions in mm
CAO..YX and MAO..YX

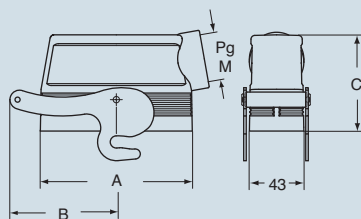

| part | A | B | C |
|---------------------|----|----|----|
| CAO 10 YX/MAO 10 YX | 73 | 66 | 70 |

dimensions in mm
CAV..YX and MAV..YX

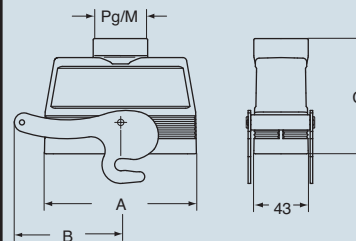

| part | A | B | C |
|---------------------|----|----|----|
| CAV 10 YX/MAV 10 YX | 73 | 66 | 85 |

CENTRAL LEVER - size 57.27



dimensions shown are not binding
and may be changed without notice

| inserts: | | page |
|----------------------|-------------------------|------------|
| CD | 40 poles + ⊕ | 49 |
| CT, CTS (10A) | 40 poles + ⊕ | 56 |
| CDD | 72 poles + ⊕ | 62 |
| CQE | 32 poles + ⊕ | 82 |
| CSH | 16 poles + ⊕ | 90 |
| CCE | 16 poles + ⊕ | 98 |
| CNE, CSE, JCNE, JCSE | 16 poles + ⊕ | 99 and 108 |
| CSS | 16 poles + ⊕ | 120 |
| CTE, CTSE (16A) * | 16 poles + ⊕ | 128 |
| CMSE | 6+2 (aux) poles + ⊕ | 137 |
| CMCE | 6+2 (aux) poles + ⊕ | 136 |
| CP | 6 poles + ⊕ | 149 |
| CX | 6/36 and 12/2 poles + ⊕ | 152÷153 |
| CX | 4/0 and 4/2 poles + ⊕ | 154 |
| MIXO | 4 modules | 156÷195 |

insert centre distance: **77.5 x 27 mm**

bulkhead mounting housings for central lever



surface mounting housings, high construction with two entries for central lever



| description | part no. | part no. | entry Pg | part no. | entry M |
|--|------------------|---------------------|----------|---------------------|---------|
| bulkhead mounting with pegs for central lever size "77.27" | CHI 16 YC | | | | |
| surface mounting, high construction, with pegs, for central lever size "77.27" | | CAP 16 YC229 | 29x2 | MAP 16 YC232 | 32x2 |

*) can be used only in bulkhead mounting housings
panel cut-out for bulkhead mounting housings in mm

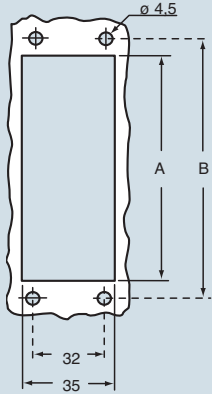

| part | A | B |
|-----------|----|-----|
| CHI 16 YC | 86 | 103 |

dimensions in mm

CHI YC

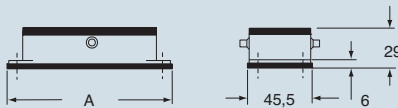

| part | A |
|-----------|-------|
| CHI 16 YC | 115.5 |

dimensions in mm

CAP YC and MAP YC

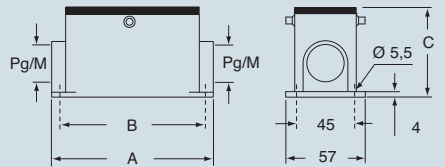

| part | A | B | C |
|-----------------------|-----|-----|----|
| CAP 16 YC / MAP 16 YC | 117 | 105 | 81 |

CENTRAL LEVER - size 77.27



dimensions shown are not binding and may be changed without notice



| inserts: | | page |
|----------------------|-------------------------|------------|
| CD | 40 poles + ⊕ | 49 |
| CDD | 72 poles + ⊕ | 72 |
| CQE | 32 poles + ⊕ | 82 |
| CSH | 16 poles + ⊕ | 90 |
| CCE | 16 poles + ⊕ | 98 |
| CNE, CSE, JCNE, JCSE | 16 poles + ⊕ | 99 and 108 |
| CSS | 16 poles + ⊕ | 120 |
| CMSE | 6+2 (aux) poles + ⊕ | 137 |
| CMCE | 6+2 (aux) poles + ⊕ | 136 |
| CP | 6 poles + ⊕ | 149 |
| CX | 6/36 and 12/2 poles + ⊕ | 152÷153 |
| CX | 4/0 and 4/2 poles + ⊕ | 154 |
| MIXO | 4 modules | 156÷195 |

insert centre distance: 77.5 x 27 mm

hoods with central lever



hoods with central lever



| description | part no. | | entry | | part no. | | entry | |
|-------------------------------|-------------|----|-------------|----|-------------|----|-------------|----|
| | | | Pg | M | | | Pg | M |
| side entry, high construction | | | | | | | | |
| size "77.27" | CAO 16 YX21 | 21 | MAO 16 YX32 | 32 | | | | |
| size "77.27" | CAO 16 YX29 | 29 | MAO 16 YX40 | 40 | | | | |
| top entry, high construction | | | | | | | | |
| size "77.27" | | | | | CAV 16 YX21 | 21 | MAV 16 YX32 | 32 |
| size "77.27" | | | | | CAV 16 YX29 | 29 | MAV 16 YX40 | 40 |

dimensions in mm
CAO..YX and MAO..YX

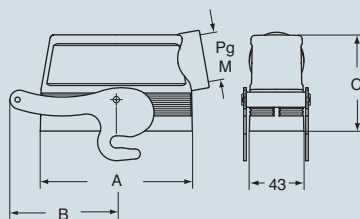

| part | A | B | C |
|---------------------|------|----|----|
| CAO 16 YX/MAO 16 YX | 93.5 | 76 | 76 |

dimensions in mm
CAV..YX and MAV..YX

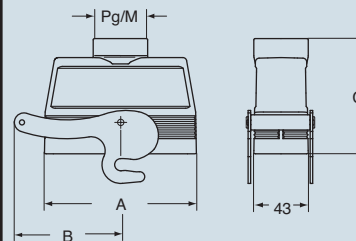

| part | A | B | C |
|---------------------|------|----|----|
| CAV 16 YX/MAV 16 YX | 93.5 | 76 | 91 |



dimensions shown are not binding and may be changed without notice

CENTRAL LEVER - size 77.27



| | | |
|----------------------------|--------------------------|---------|
| inserts: | | page |
| CD | 64 poles + ⊕ | 51 |
| CT, CTS (10A) | 64 poles + ⊕ | 57 |
| CDD | 108 poles + ⊕ | 64 |
| CQE | 46 poles + ⊕ | 83 |
| CSH | 24 poles + ⊕ | 91 |
| CCE | 24 poles + ⊕ | 100 |
| CNE, CSE, JCNE, JCSE | 24 poles + ⊕ 101 and 109 | |
| CSS | 24 poles + ⊕ | 121 |
| CTE, CTSE (16A) *) | 24 poles + ⊕ | 129 |
| CMSE | 10+2 (aux) poles + ⊕ | 139 |
| CMCE | 10+2 (aux) poles + ⊕ | 138 |
| CX | 4/8 poles + ⊕ | 155 |
| MIXO | 6 modules | 156÷195 |

insert centre distance:
104 x 27 mm

bulkhead mounting housings for central lever



surface mounting housings, high construction with two entries for central lever



| description | part no. | part no. | entry Pg | part no. | entry M |
|---|------------------|---------------------|----------|---------------------|---------|
| bulkhead mounting with pegs for central lever size "104.27" | CHI 24 YC | | | | |
| surface mounting, high construction, with pegs, for central lever size "104.27" | | CAP 24 YC229 | 29x2 | MAP 24 YC232 | 32x2 |

*) can be used only in bulkhead mounting housings
panel cut-out for bulkhead mounting housings in mm

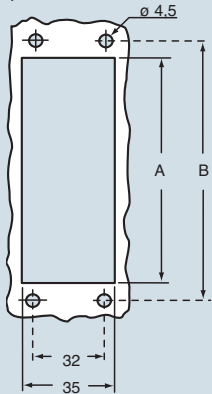

| part | A | B |
|-----------|-----|-----|
| CHI 24 YC | 112 | 130 |

dimensions in mm

CHI YC

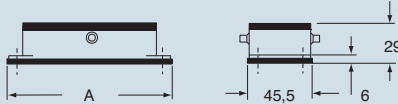

| part | A |
|-----------|-------|
| CHI 24 YC | 142.5 |

dimensions in mm

CAP YC and MAP YC

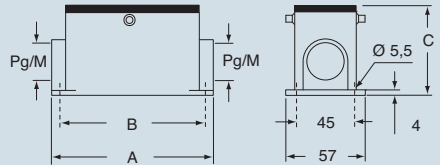

| part | A | B | C |
|-----------------------|-----|-----|----|
| CAP 24 YC / MAP 24 YC | 144 | 132 | 81 |

CENTRAL LEVER - size 104.27



dimensions shown are not binding
and may be changed without notice

| | | |
|----------------------------|----------------------|-------------|
| inserts: | | page |
| CD | 64 poles + ⊕ | 51 |
| CDD | 108 poles + ⊕ | 64 |
| CQE | 46 poles + ⊕ | 83 |
| CSH | 24 poles + ⊕ | 91 |
| CCE | 24 poles + ⊕ | 100 |
| CNE, CSE, JCNE, JCSE | 24 poles + ⊕ | 101 and 109 |
| CSS | 24 poles + ⊕ | 121 |
| CMSE | 10+2 (aux) poles + ⊕ | 139 |
| CMCE | 10+2 (aux) poles + ⊕ | 138 |
| CX | 4/8 poles + ⊕ | 155 |
| MIXO | 6 modules | 156÷195 |

insert centre distance:
104 x 27 mm

hoods with central lever



hoods with central lever



| description | part no. | entry Pg | part no. | entry M | part no. | entry Pg | part no. | entry M |
|--|---|-------------|-------------|-------------|-------------|----------|-------------|---------|
| | side entry, high construction size "104.27" size "104.27" | CAO 24 YX21 | 21 | MAO 24 YX32 | 32 | | | |
| | CAO 24 YX29 | 29 | MAO 24 YX40 | 40 | | | | |
| top entry, high construction size "104.27" size "104.27" | | | | | CAV 24 YX21 | 21 | MAV 24 YX32 | 32 |
| | | | | | CAV 24 YX29 | 29 | MAV 24 YX40 | 40 |

dimensions in mm
CAO..YX and MAO..YX

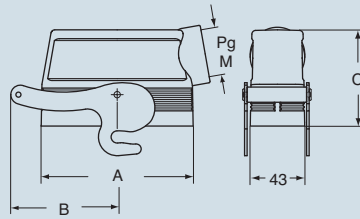

| part | A | B | C |
|---------------------|-----|----|----|
| CAO 24 YX/MAO 24 YX | 120 | 84 | 76 |

dimensions in mm
CAV..YX and MAV..YX

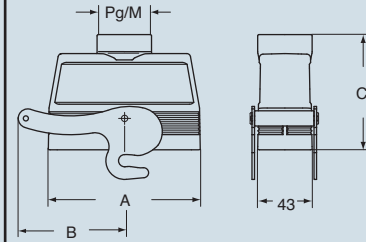

| part | A | B | C |
|---------------------|-----|----|----|
| CAV 24 YX/MAV 24 YX | 120 | 84 | 91 |

CENTRAL LEVER - size 104.27



dimensions shown are not binding
and may be changed without notice

| | | |
|----------------------------|----------------------|-------------|
| inserts: | | page |
| CD | 64 poles + ⊕ | 51 |
| CDD | 108 poles + ⊕ | 64 |
| CQE | 46 poles + ⊕ | 83 |
| CSH | 24 poles + ⊕ | 91 |
| CCE | 24 poles + ⊕ | 100 |
| CNE, CSE, JCNE, JCSE | 24 poles + ⊕ | 101 and 109 |
| CSS | 24 poles + ⊕ | 121 |
| CMSE | 10+2 (aux) poles + ⊕ | 139 |
| CMCE | 10+2 (aux) poles + ⊕ | 138 |
| CX | 4/8 poles + ⊕ | 155 |
| MIXO | 6 modules | 156÷195 |

insert centre distance:
104 x 27 mm

inclined hoods with central lever with side entry



NEW

inclined hoods with central lever with top entry



NEW

| description | part no. | entry Pg | part | entry M | part no. | entry Pg | part no. | entry M |
|--|---|--------------------|------|--|--------------------|----------|----------|--|
| | side entry, high construction size "104.27" size "104.27" | CIO 24 YX36 | 36 | MIO 24 YX40 MIO 24 YX50 | 40 50 | | | MIV 24 YX40 MIV 24 YX50 |
| top entry, high construction size "104.27" size "104.27" | | | | | CIV 24 YX36 | 36 | | |

dimensions in mm
CIO..YX and MIO..YX

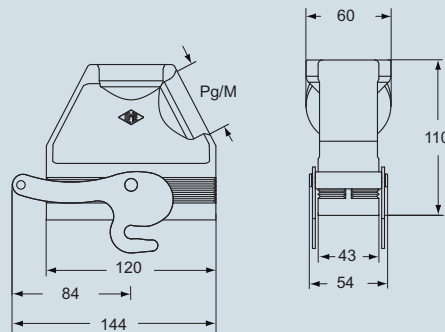

dimensions in mm
CIV..YX and MIV..YX

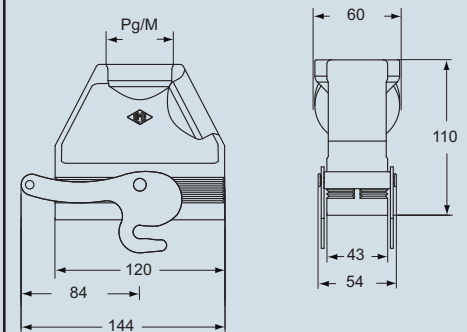

Even when coding is not required, it is recommended to use CRM and CRF pins with CD and CDD inserts and CRM CX and CRF CX pins with MIXO inserts to reduce movements when fitting and removing the connectors and to avoid contact damages. Within this scope, the DIN 43 652 standard requires a maximum angular longitudinal fluctuation of ±5°.

dimensions shown are not binding and may be changed without notice

CENTRAL LEVER - size 104.27