

## Rod ends, female thread; 2nd generation: KBRM CL and KBLM CL

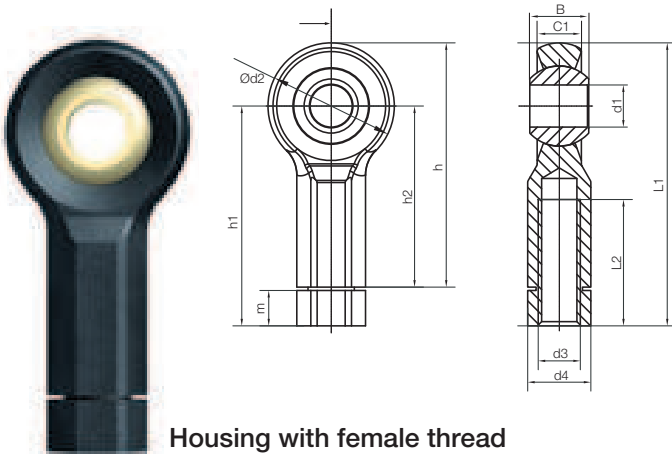

Housing with female thread

- Smooth design has no dirt traps
- Compensation of misalignment
- Light weight
- Excellent corrosion resistance
- Design with metal sleeve for higher torque strength available
- Standard spherical bearing: iglidur® W300



### Order key

### KB...M-06 CL

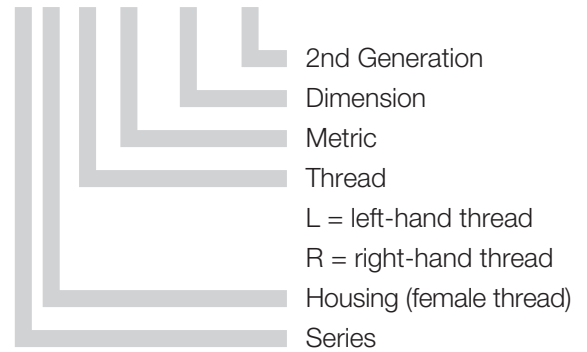

### Material:

Housing: **igumid G** ► page 983

Spherical ball: **variable** ► page 667

## Technical Data

Part number		Max. static tensile strength		Max. static radial load		Min. thread depth	Max. torque strength	Max. torque through ball		Weight
Right-hand thread	Left-hand thread	Short term [N]	Long term [N]	Short term [N]	Long term [N]	Thread [mm]	Inner threading [Nm]	Standard without MH [Nm]	Standard with MH [Nm]	[g]
<b>KBRM-06 CL</b>	<b>KBLM-06 CL</b>	1,400	700	300	150	8	0.75	10	15	4.5
<b>KBRM-08 CL</b>	<b>KBLM-08 CL</b>	2,100	1,050	500	250	11	2.0	12	40	8.6
<b>KBRM-10 CL</b>	<b>KBLM-10 CL</b>	3,100	1,550	800	400	13	3.0	20	50	14.1

## Dimensions [mm]

Part number		d1	d2	d3	d4	B	C1	h	h1	h2	L2	L1	m	Max. pivot angle $\alpha$
Right-h. thread	Left-h. thread	E10												
<b>KBRM-06 CL</b>	<b>KBLM-06 CL</b>	6	20	M06	SW10	9	7	40	36.5	30	20	46.5	5.7	40°
<b>KBRM-08 CL</b>	<b>KBLM-08 CL</b>	8	24	M08	SW13	12	9	48	44.3	36	25	56.3	7.5	35°
<b>KBRM-10 CL</b>	<b>KBLM-10 CL</b>	10	30	M10	SW15	14	10.5	58	52.2	43	30	67.2	8.4	35°

For rod ends with **metal insert** please add **MH** to the part number, e.g. **KBRM-10 CL MH (Inner-Ø: 10 mm)**. For another spherical bearing material please add **J, R** or **X** to the part number, e.g. **KBRM-10 CL J**.

## Spherical ball material to choose ► page 667



RKM:  
low-cost



XKM:  
high temperatures



JKM: Low moisture absorption



W300: standard spherical bearing with metal sleeve