

Hybrid bearing – roll and slide

drylin® W hybrid bearings offer a unique combination of plain and roller bearings. At a defined installation position, the required driving torque reduces significantly due to the maintenance-free roller bearings. Shear forces and shock loads are absorbed by the plain bearing. The hybrid bearing is ideal for manual adjustments, especially in door slides.

- Shaft-mounted plastic rollers
- Liner made of iglidur® J
- Low drive force needed
- Friction: 0.04–0.05 μ
- Cost-effective
- Can be combined with 7 linear profile rails

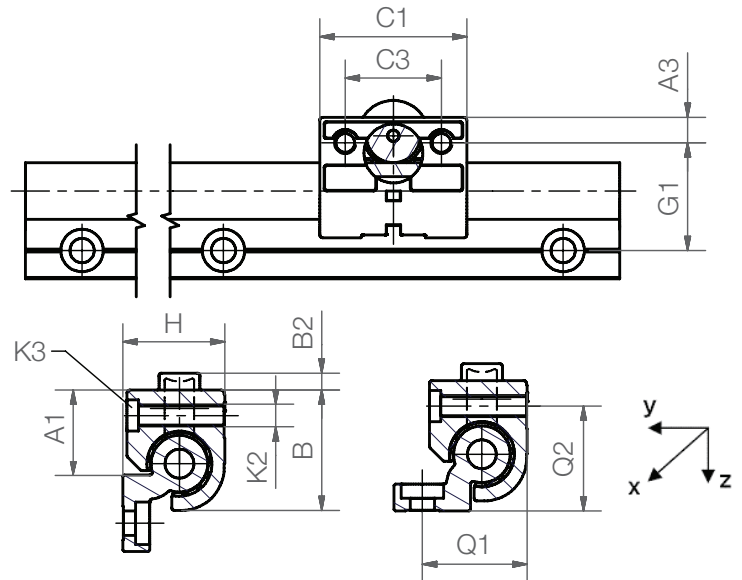
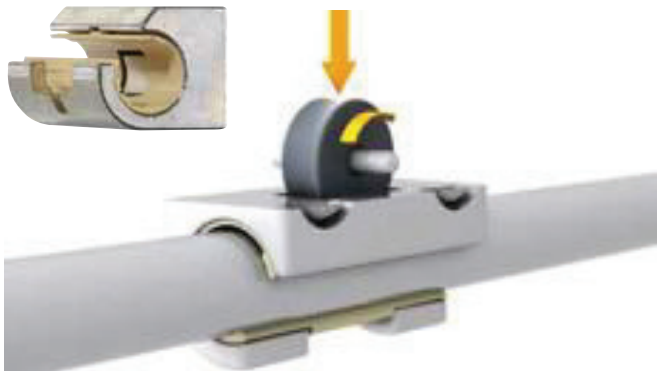

Shown installation position is not possible for combination of WJRM-01-10 with rail WS-10/WS-10-40/WS-10-80

drylin® W Hybrid Housing Bearing, Round – Load Data and Dimensions [mm]

Part number	Static load capacity C_0	Dyn. load capacity C_{z+} at total running distance (km)			$F \cdot v$
		10	100	200	
	[N]	[N]	[N]	[N]	max. [N · m/s]
WJRM-01-10	250	250	90	50	50
WJRM-01-16	400	400	140	70	80
WJRM-01-20	550	550	200	100	80

drylin® W Hybrid Housing Bearing, Round – Load Data and Dimensions [mm]

Part number	Friction in +z direction	Weight [g]	A1	A3	B	B2	C1	C3	G1	H	K2	K3	Q1	Q2
WJRM-01-10	< 0.1	46	16.5	6.5	26	2,5	35	22	27	18	M6	M5	–	–
WJRM-01-16	< 0.1	131	25	9	34.5	5	48	30	33	27	M8	M6	32	28
WJRM-01-20	< 0.1	232	30	9	42.5	6	52	34	38	36	M8	M6	37	37



drylin® W guide rail ► page 835



delivery from stock
time



prices price list online
www.igus.eu/drylinSpecialists



Adjustment of control panel unit



Adjustment of sliding door tool magazine



Adjustment of wood panel

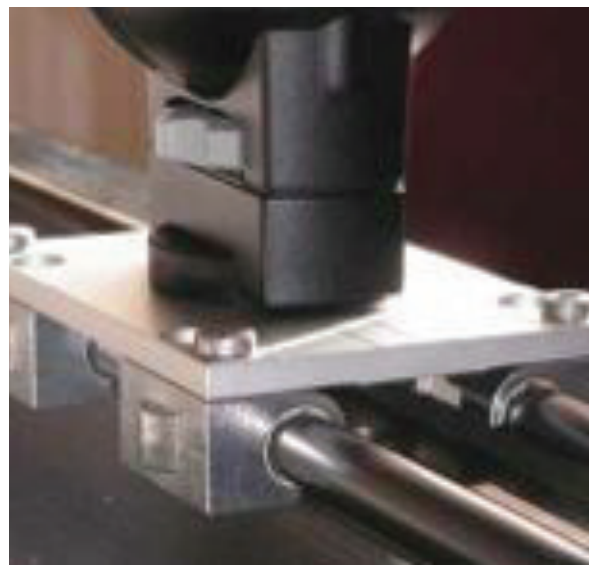

Adjustment of camera mounting slide

► www.igus.eu/camera