

DryLin® SHT | Product Range | Trapezoidal Leadscrew

SHTP – Economical – Solid plastic

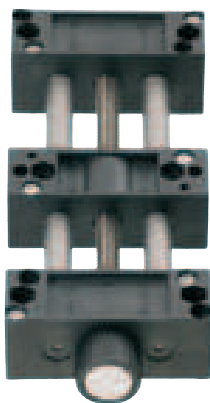

- Solid polymer design
 - Low weight
 - Cost-effective
 - Corrosion-resistant
 - Available accessories
- page 922



Order key
complete ► page 897

SHTP-01-12-AWM

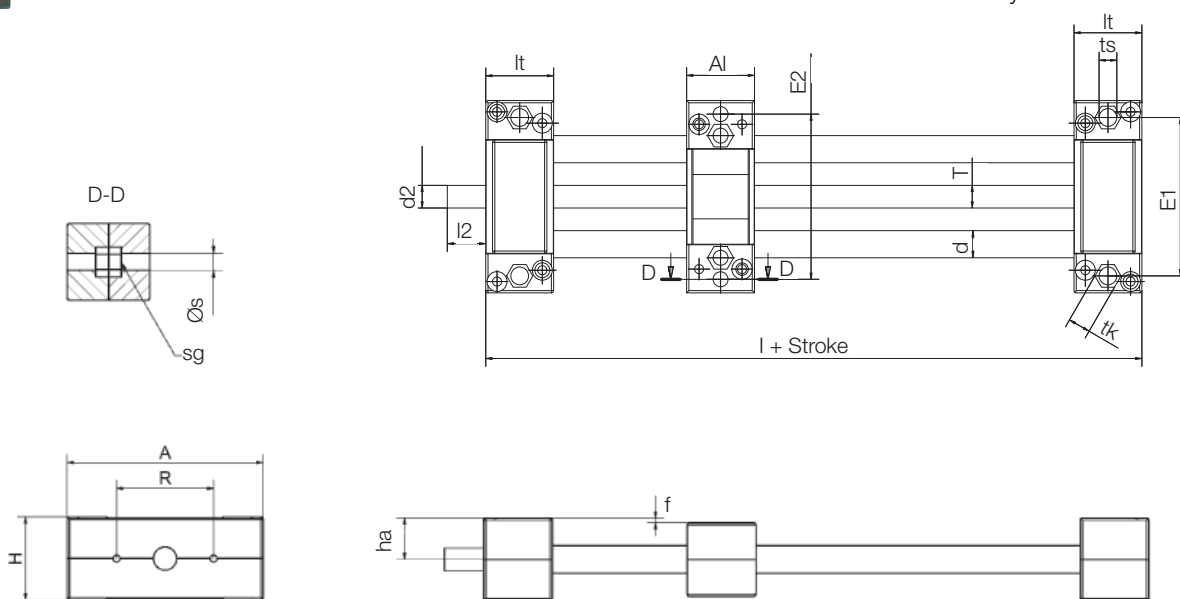

Technical Data

Part number	Max. length of stroke [mm]	Aluminum shaft		More information
		Weight [kg]	Additional [kg] (per 100 mm)	
SHTP-01-12	500	0.35	0.11	Liners and trapezoidal leadscrew nut made of iglidur® J
SHTP-02-12	500	0.35	0.11	Bearing and nut integrated into the carriage

Dimensions [mm]

Part number	A	Al	H	E1	E2	E3	l	R	f	lt	tk	ts
SHTP-01-12	85	30	36	70	73	–	90	42	2	30	10	6.0
SHTP-02-12	85	30	36	70	73	–	90	42	2	30	10	6.0

Part number	s	sg	d	T	l2	d2*	ha	Max. static load-bearing capacity	
								axial [N]	radial [N]
SHTP-01-12	6.3	M6	12	TR 10 x 2	17	TR 10 x 2	18	200	800
SHTP-02-12	6.3	M6	12	TR 10 x 2	17	TR 10 x 2	18	200	800

* Standard versions supplied with leadscrew end unmachined



delivery 2–3 days
time ► page 895



prices price list online
www.igus.eu/eu/DryLinSHT



order part number
example SHTP-01-12